

Instruction guide for RE601i - RE602i series wall mount remotes

1. PRODUCT APPEARANCE

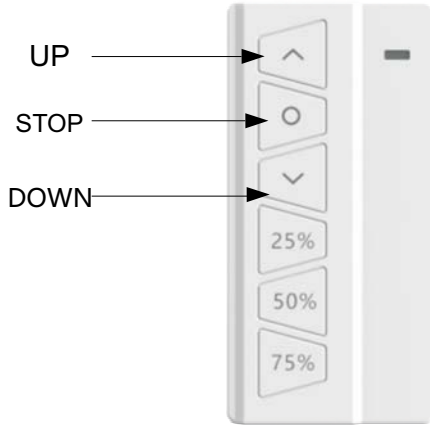

RE 601i

Single Channel
 Featured 3 intermediate Limits
 Position: 25%,50%,75%

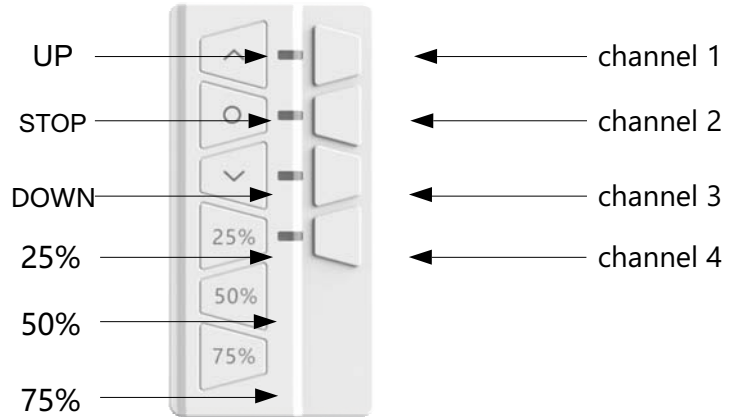

RE602i

Four Channel
 Featured 3 intermediate Limits
 Position: 25%,50%,75%



RE601iPlus

Single Channel

US Standard
 Decora Plate



RE602iPlus

Four Channel

2. TECHNICAL DATA

Power: 3v Model CR2032

Working Temperature: -20°C to +60°C

Code: rolling code

Current: $\leq 16\text{mA}$

Frequency: 433.92MHz

Instruction guide for RE601i - RE602i series wall mount remotes

3. CODE LEARNING

single-channel remote

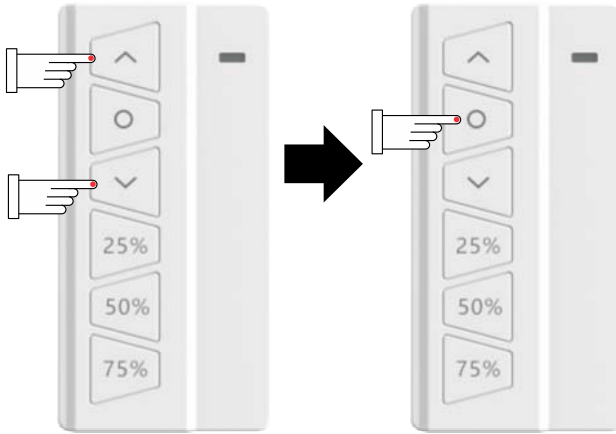

Make the motor at learning state (refer to motor's user manual), press remote's UP and DOWN buttons simultaneously once, then short press STOP button once, the motor vibrates, the remote is paired to the motor.

4 channel remote

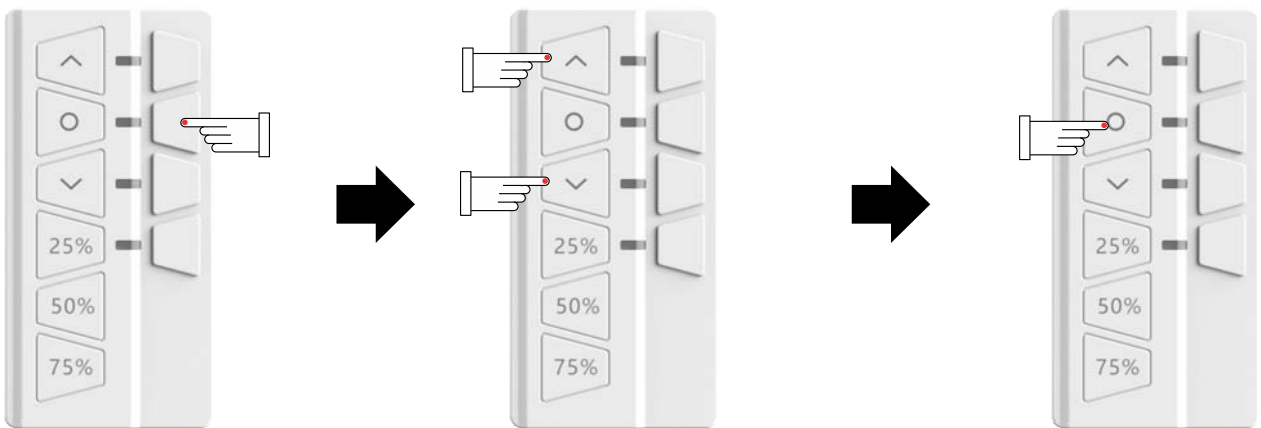

Short press the Channel Switch Button to select a channel (from 1 to 4), once selected, the corresponding light will shine.

Press UP and DOWN buttons simultaneously once.

Then short press the STOP button, now the code learning of the selected channel is successful. Other channels to learn code in the same way.

4. GROUP CONTROL

Example: RE602 series could set four Channels, each channel with corresponding button and light.

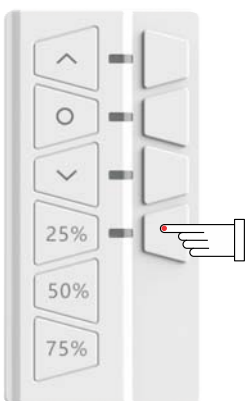

a) During Sleep Mode (all lights are off), press any one switch button once, could check which channel have been set (corresponding light will shine).

b) During channel checking (channel light are on), press the channel switch button again. If the channel hasn't ever been set, it will be set now, if the channel have ever been set, it will be deleted now and the corresponding light off.

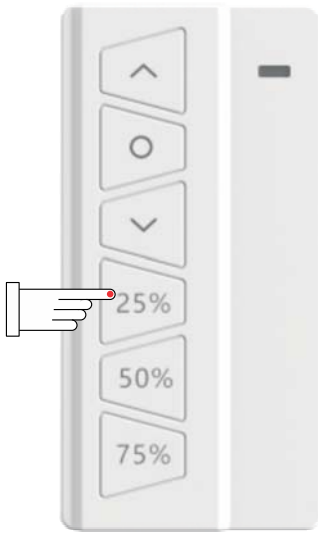
Instruction guide for RE601i - RE602i series wall mount remotes**5. PERCENTAGE CONTROL**

After code learning and UP & DOWN limit set, press the left buttons 25%,50%,75%, could control the percentage.

6. BRACKET INSTALLATION**Way 1** Direct wall installation**Way 2** US Standard Decora Plate**! Note:**

If you need set group control, you have to add or delete channels within 3-4s after checking channel.

Only after code learning and limits are set, you can control the percentage.

You'd better not press the remote's buttons too long so as to prolong the battery.

The button press should be about 0.5s with 1s interval.

The remote will stop working if the battery is in low power. Please replace the battery in this case.