

Instruction guide for RE101, RE102, RE103 series remotes

1. PRODUCT APPEARANCE

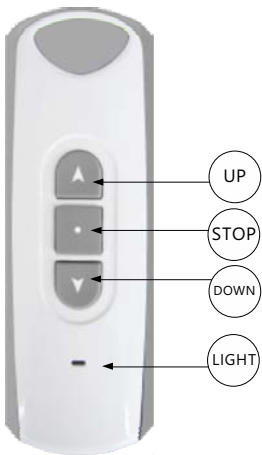

RE101 single channel

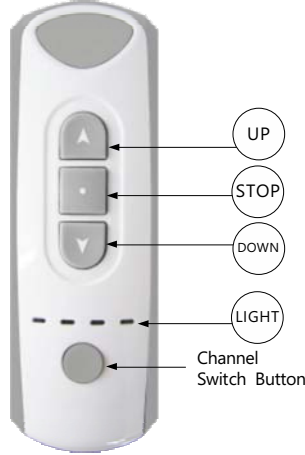

RE102 4 channel

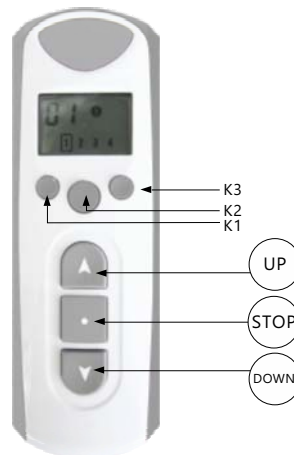

RE103 4C 4 channel

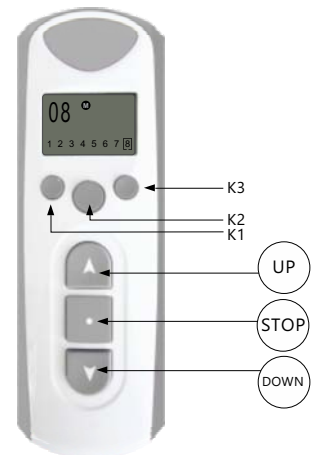

RE103 8C 8 channel

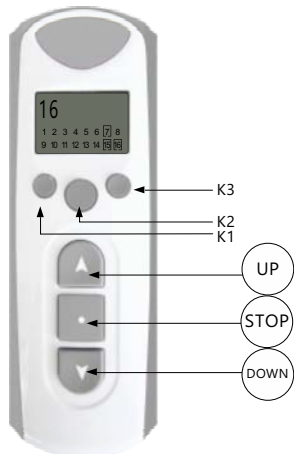

RE103 16C 16 channel

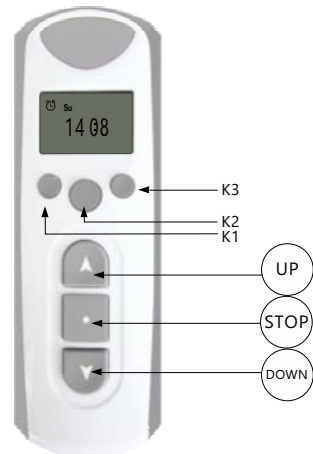

RE103 1T single channel timer

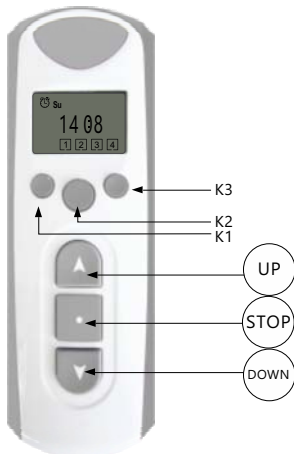

RE103 4T 4 channel timer

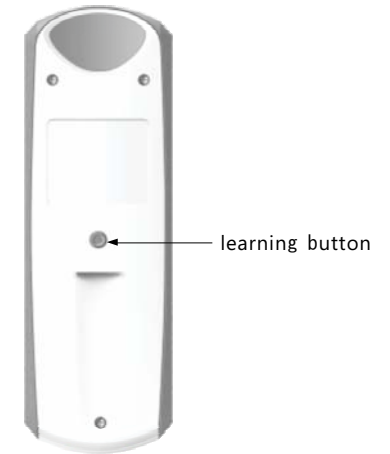

learning button

2. TECHNICAL DATA

- Power: 3V Model: CR2430
- Protection Index: IP20
- Working Temperature: -10°C to +60°C (LCD remote)
- Working Temperature: -20°C to +60°C (Non- LCD remote)
- Currency: ≤12mA
- Code: Rolling Code
- Frequency: 433.92MHz

3. CODE LEARNING

01. single channel remote

Press Up and Down buttons simultaneously once, then short press Stop button once.

02.4 channel remote

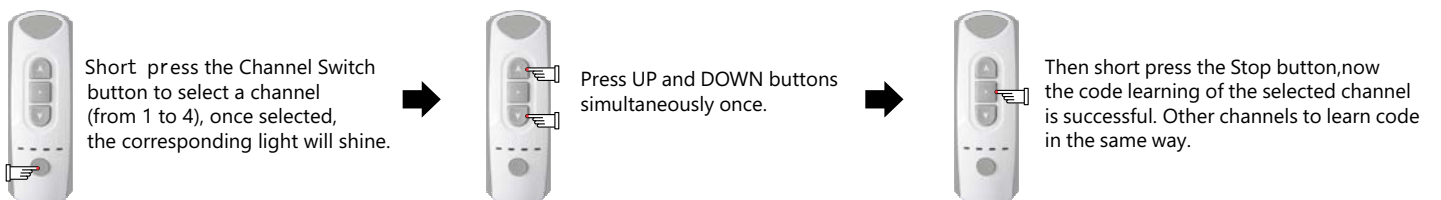

03. LCD multi-channel remote (take RE103-8C as an example)

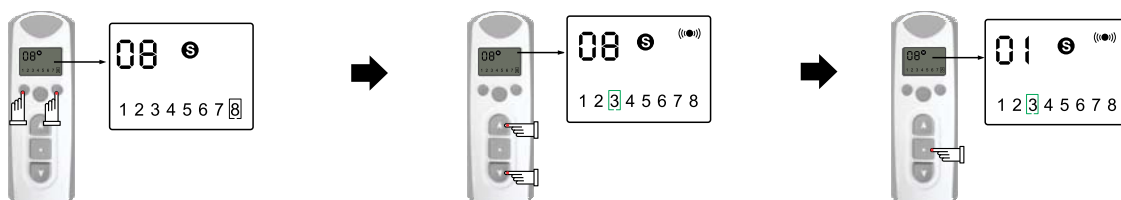

The figure on upper left corner of the screen shows the current channel. Short press K1/K3 to choose any channel from 1 to 8.

Choose one channel, then press UP and DOWN buttons simultaneously once.

Then short press the STOP button once, now the code learning of current channel is successful.

Instruction guide for RE101, RE102, RE103 series remotes

4. SINGLE CONTROL

Press K1/K3 button to select a channel, then the corresponding motor can be controlled by the remote through UP/STOP/ DOWN button.

5. GROUP CONTROL (4 CHANNEL REMOTE)

Short press the Channel Switch button to select different channels (from 1 to 4), once selected, corresponding light will shine.



Note: If all of the 4 lights are on, it means the remote is in Group Control state.

6. GROUP CONTROL (LCD REMOTE) Short press K2 button to choose group control **M** or Single control **S**

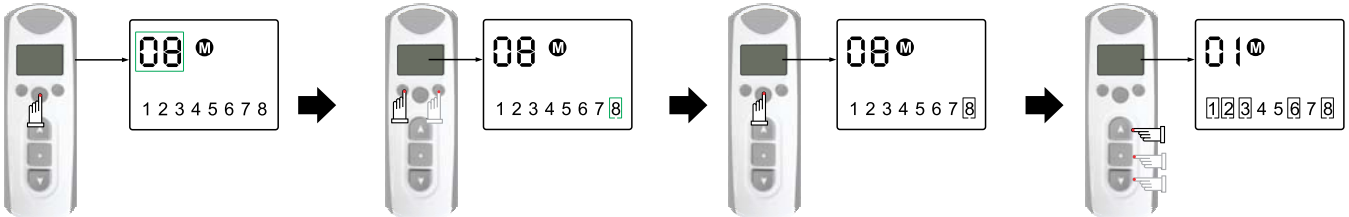

Long press K2 for 2s to enter Group Control mode, the current channel on the upper left corner of the screen will shine.

Short press K1/K3 to choose channels into your group, for example channel 8 as the picture shows.

Short press K2 to confirm, same method for the other channels.

Press UP/STOP/DOWN button to exit the setting.

7. DELETE GROUP CONTROL

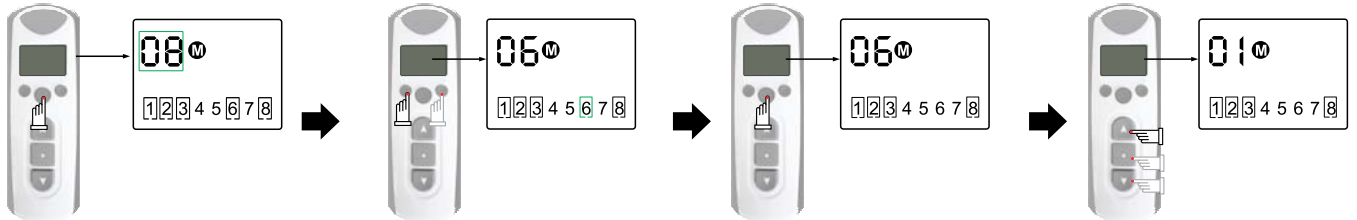

Long press K2 for 2s to enter Group Control mode, the current channel on the upper left corner of the screen will shine.

Short press K1/K3 to choose channels out your group, for example channel 6 as the picture shows.

Short press K2 to confirm, same method for the other channels.

Press UP/STOP/DOWN button to exit the setting.

Note: whether in **M** or **S** mode, the current channel is always selected.

8. RE103-T

01. Time Setting

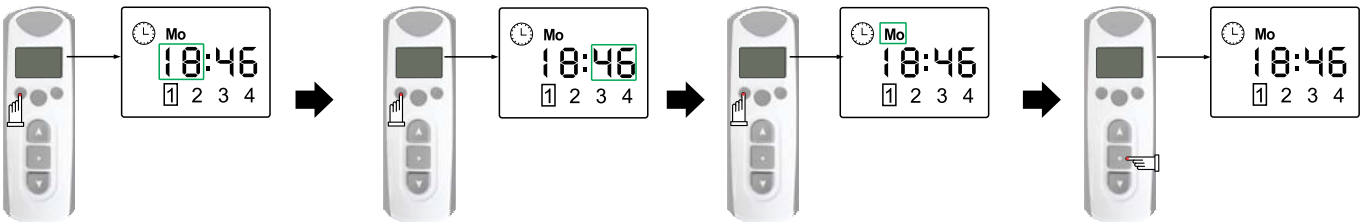

Press K1 button to enter hour setting page, now the hour figure will shine. Press UP/DOWN button to adjust the hour figure.

Once the hour setting is finished, press K1 again to adjust minute, the minute figure will shine. Press UP/DOWN button to adjust the figure.

Once the minute setting is finished, press K1 again to adjust weekday, the weekday figure will shine. Press UP/DOWN button to adjust the weekday.

After setting, press STOP button to exit and go back to the initial page.

02. Timing Setting (set different time points to make the motor close or open)

In the initial page, press K2 to enter timing setting page, there is a timing clock on the upper left corner.

You can respectively set 8 opening time points and 8 closing time points, in total 16 points. 1~8

Press K2 to cycle among 16 time points. Press K3 to choose the output channels which you want (single channel or 4 channels)

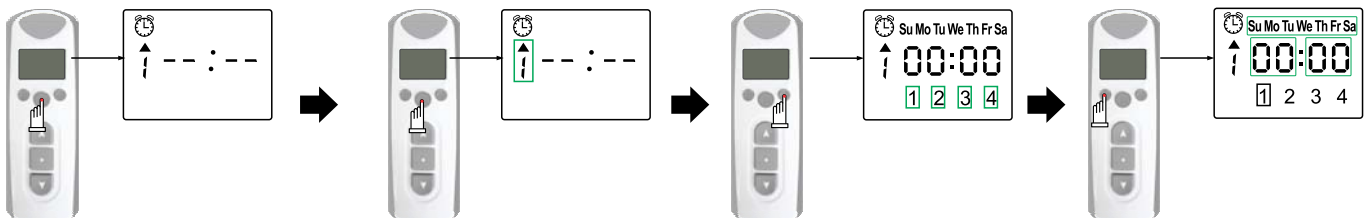

Press K2 to enter timing setting page

Press K2 again to select one point among 16 timing points

Press K3 to choose you wanted channel (single channel or 4 channels).

Press K1 to set time (in the same way of Time Setting above).

Instruction guide for RE101, RE102, RE103 series remotes

Once one time point is set, press K2 again to select other time points to set time.

Press STOP button to exit the setting.

03. Close Timing Function

Press K2 to enter timing setting page.

Press K2 again to select one point that need to be closed.

Press K3 until above display appears, which means the point has closed. Press K3 again to retrieve this point.

After setting, press STOP button to exit and go back to the initial page.

9. RE103-IT

01. Time Setting

In the same way as RE103-4T Time Setting

02. Timing Setting (set different time points to make the motor to close or open)

In the initial page, press K2 to enter timing setting page, there is a timing clock on the upper left corner. You can respectively set 8 opening time points and 8 closing time points, in total 16 points. $\uparrow \sim \downarrow$ Press K2 to cycle among 16 time points.

Press K2 to enter timing setting page.

Press K2 again to select one point among 16 timing points.

Press K3 to enter time setting page, then set the time points in the same way as above time setting.

Once one time point is set, press K2 again to select other time points to set time.

03. Close Timing Function

Press K2 to enter timing setting page.

Press K2 again to select one point that needs to be closed.

Press K3 once to delete the point. Press K3 again to retrieve this point.

After setting, press STOP button to exit and go back to the initial page.

04. Stopwatch Function

In the initial page, press K3 to enter Stopwatch page.

If you want to exit from stopwatch page, press K3 again to go back to initial page.

Note:

The remote must enter into timing setting page if you want to set timing points (there is a timing clock on the upper left), otherwise, the setting is invalid. If there is no timing clock on the upper left, hold STOP button and press k2 within 10 seconds, then the timing clock will be there.

You'd better not press remote's buttons too long. Each pressing is about 0.5s and the pressing interval is about 1s.

The remote will stop working if the battery is in low power. Please replace the battery in this case.