

1. TECHNICAL SPECIFICATIONS

Power: AC 120v/60Hz
Protection Index: IP 44

Up to 15 remotes (or channels) may be assigned to each motor
Thermal protection will engage after 4 minutes of continuous running

2. WIRE CONNECTIONS

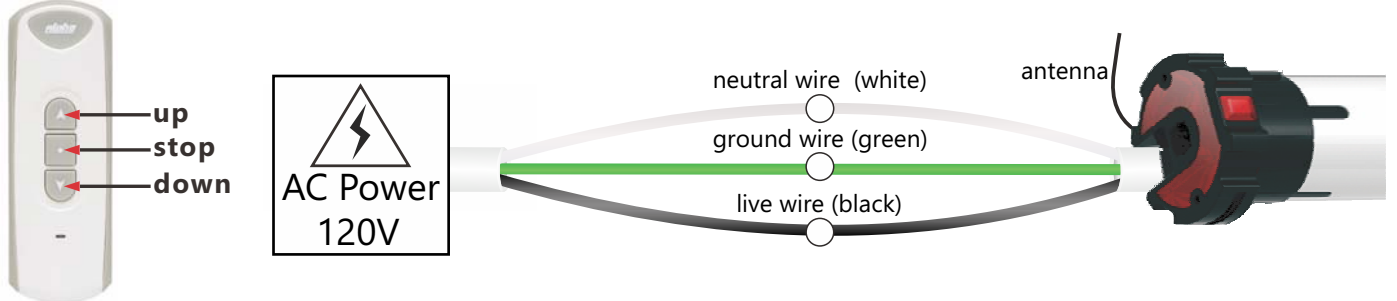

3. ASSIGNING A REMOTE TO A MOTOR (you have 10 seconds to complete the task)

METHOD A. Only works for the first remote assigned to the motor

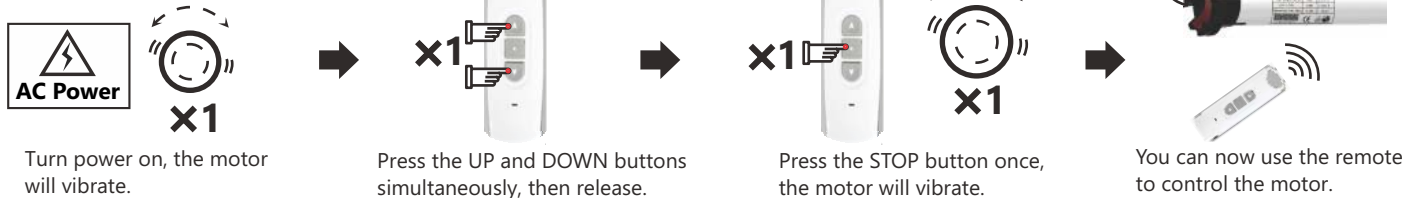

METHOD B. Can be used at any time.

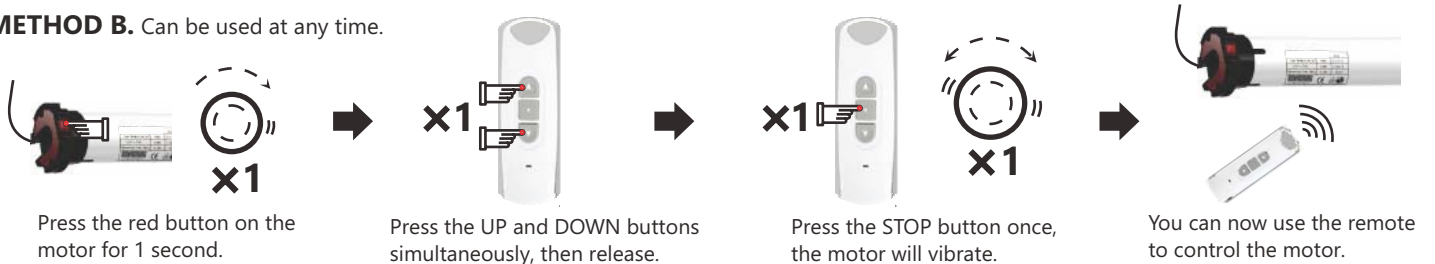

METHOD C. (Use Method C, if Method A or B do not work) Can only be used if you cut and restore power to the motor 3 times. You must allow 5 seconds before restoring power each time and you must allow the motor to vibrate properly each time. After the third cycle, you may assign the remote.

4. CHANGING THE MOTOR'S DIRECTION

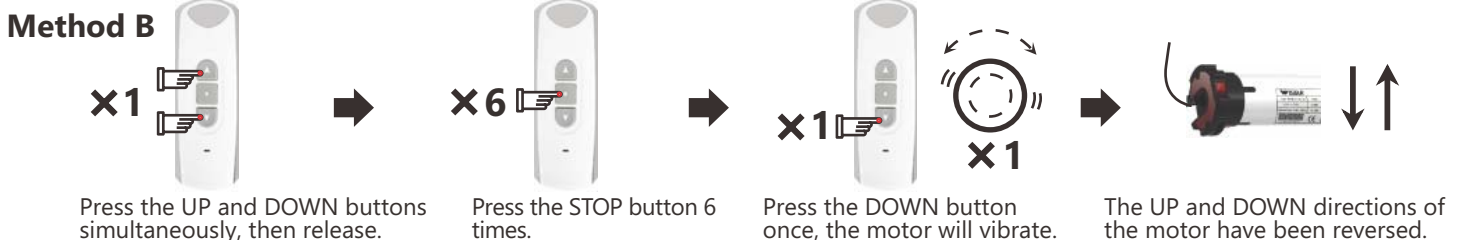
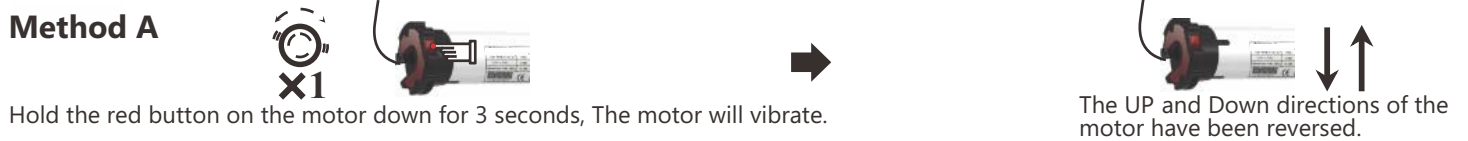

5. TURN ON "STEP BY STEP" MODE

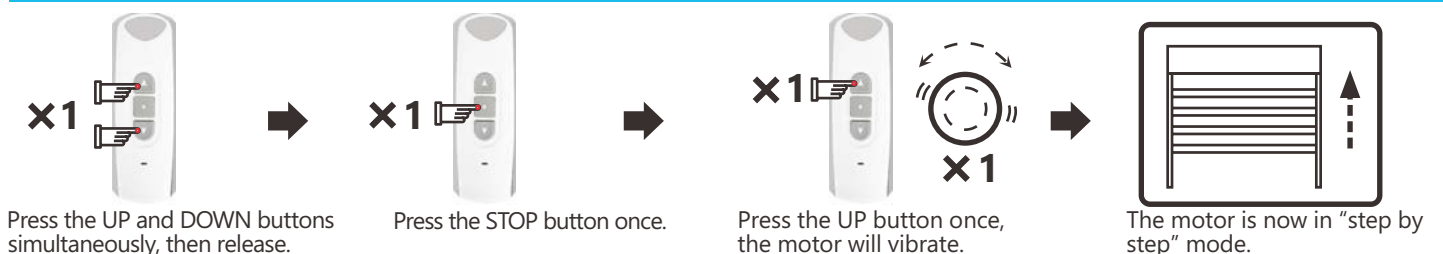

6. TURN OFF "STEP BY STEP" MODE (motor will run up and down as normal)



Press the UP and DOWN buttons simultaneously, then release.



Press the STOP button once.



Press the DOWN button once, the motor will vibrate.

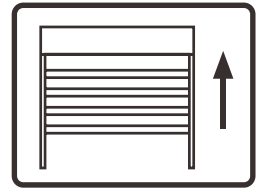

The motor will now run normally.

7. SETTING THE TOP LIMIT (firstly, move the blind to the desired position)

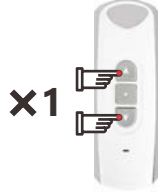

Press the UP and DOWN buttons simultaneously, then release.



Press the STOP button twice.



Press the UP button once, the motor will vibrate.

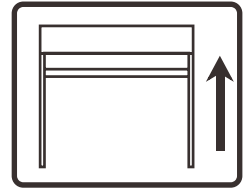

Top limit is now set.

8. SETTING THE BOTTOM LIMIT (firstly, move the blind to the desired position)

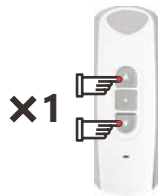

Press the UP and DOWN buttons simultaneously, then release.



Press the STOP button twice



Press the DOWN button once, the motor will vibrate.

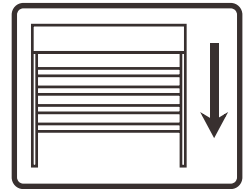

Bottom limit is now set.

9. DELETING THE TOP LIMIT (firstly, move the blind to the desired position)

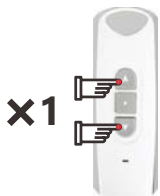

Press the UP and DOWN buttons simultaneously, then release.



Press the STOP button 4 times.



Press the UP button once, the motor will vibrate.

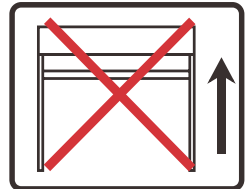

Top limit is deleted.

10. DELETING THE BOTTOM LIMIT (firstly, move the blind to the desired position)

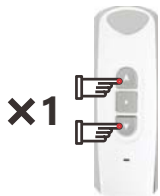

Press the UP and DOWN buttons simultaneously, then release.



Press the STOP button 4 times.



Press the DOWN button once, the motor will vibrate.

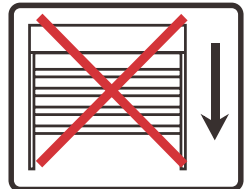

Bottom limit is deleted.

11. ASSIGNING AN EXTRA REMOTE (OR CHANNEL) TO A MOTOR VIA THE ORIGINAL REMOTE

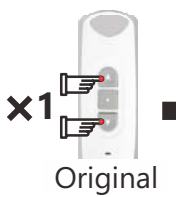

Press the UP and DOWN buttons simultaneously, then release.



Press the STOP button 8 times, the motor will vibrate.



Press the UP and DOWN buttons simultaneously, then release.

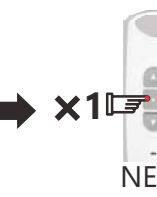

Press the STOP button once, the motor will vibrate.



You can now use the new remote to control the motor.

12. DELETING A REMOTE (OR CHANNEL) FROM A MOTOR

Method A. This will delete the individual remote (or channel) you are using.

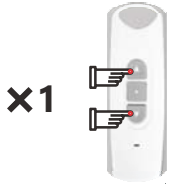

Press the UP and DOWN buttons simultaneously, then release.



Press the STOP button 7 times.

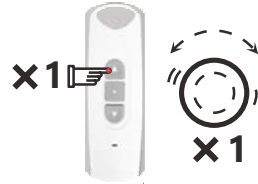

Press the UP button once, the motor will vibrate.



This remote (or channel) has now been deleted from the motor.

Method B. WARNING: This will delete ALL remotes assigned to the motor

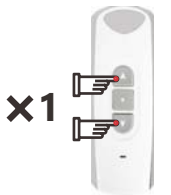

Press the UP and DOWN buttons simultaneously, then release.



Press the stop button 6 times.



Press the UP button once, the motor will vibrate.



All remotes have been deleted from the motor.

13. SETTING THE THIRD LIMIT (midway position, somewhere between top and bottom limits)

(firstly, move the blind to the desired position)



Press the STOP button 4 times.



The motor will vibrate.



Hold down for 2 seconds
Holding down the stop button for 2 seconds will send the motor to the third limit position.

14. CHANGING THE THIRD LIMIT (firstly, move the blind to the desired position)



Press the STOP button 4 times.



The motor will vibrate.



Hold down for 2 seconds
Holding down the stop button for 2 seconds will send the motor to the third limit position.

NOTE: The third limit will be deleted automatically if either the top or bottom limits are deleted.

15. OPTIONAL FUNCTION: WORKING WITH MANUAL SWITCH

A. The 6-wire motor's default software is for Dual-Control switch. Connect motor and switch as per below indication.

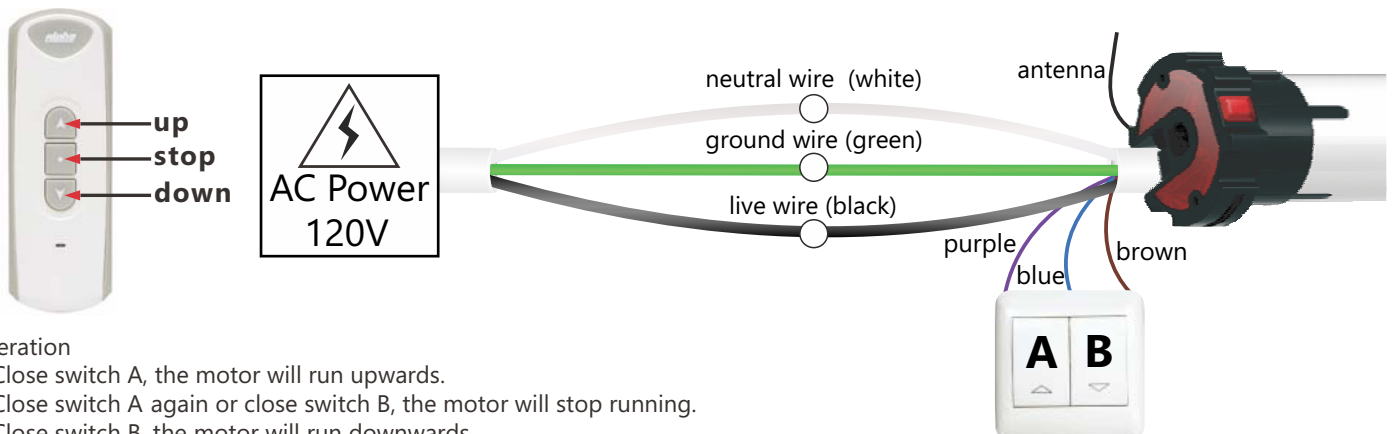

Operation

- 1) Close switch A, the motor will run upwards.
- 2) Close switch A again or close switch B, the motor will stop running.
- 3) Close switch B, the motor will run downwards.

SINGLE-CONTROL SWITCH (can be compatible with 5-core wires WSER tubular motor)

B. If you want to use the motor with Single-Control switch, please connect motor and switch as per below indication first.

Then use an assigned remote to do following steps:

-Short press remote's UP & DOWN button simultaneously and release.

-Short press remote's STOP button 7 times.

-Short press DOWN button one time and release, the motor jiggles.

Now you can use the Single-Control switch to control the tubular motor properly.

The tubular motor will run Up-Stop-Down Stop-Up-Stop cycle when the switch is pressed each time.

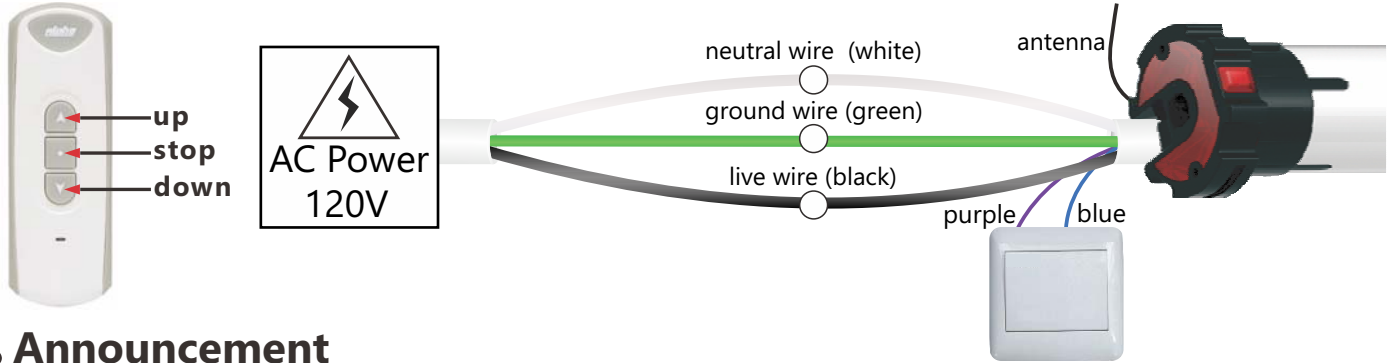
**⚠ Announcement**

1. The RE101 remote has been used as an example here in diagrams. All Alpha remotes are compatible with these motors.
2. Strong local RF levels from other equipment may affect some setup functions. If a step fails, simply repeat the process.
3. Be careful not to speed through the setup process until you are 100% sure of what you are doing.
4. These motors and accessories are not toys, do not allow children to play with them.
5. Ambient operating temperature is: -10°C to +55°C
6. All Alpha products may be subject to change without notice.

Handy Tips

1. If this motor is used on an awning and works with the Alpha RS001 wind-lightsensor or RS005 motion sensor, there is constant radio communication between the motor and sensor. If the motor doesn't receive radio communication from the sensor for 35 minutes after opening, the motor will automatically close the awning as a protective measure. This indicates that there is either a problem that needs investigation, or in the case of the motion sensor that the batteries might need changing.
2. Always roll the blind down and up before setting the top limit. Failure to do so may result in a change of limit position due to a change in blind tension. Simply setting the bottom limit first will prevent this happening.
3. When pressing up and down simultaneously during setup, be as precise as possible. Ideally it should sound like one button click when both are pressed.
4. If you catch yourself making an error during a setup process, stop and allow 10 seconds for the motor to time out, then try again.
5. Do not hold any buttons down during setup process unless specifically told to do so. A half second press should be plenty and allow 1 second between presses.
6. If you are using a multi-channel remote, make certain that it is on the correct channel before you assign it to a motor. This is a common mistake.