

# Emitter Instruction for RE601-i/RE602-i series

## 1. Product appearance

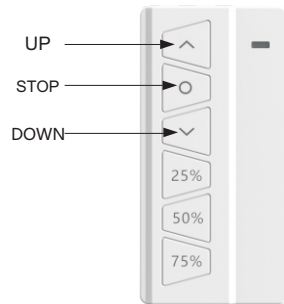

WSRE601-i  
Single Channel

Featured 3 intermediate Limits  
Position: 25%,50%,75%

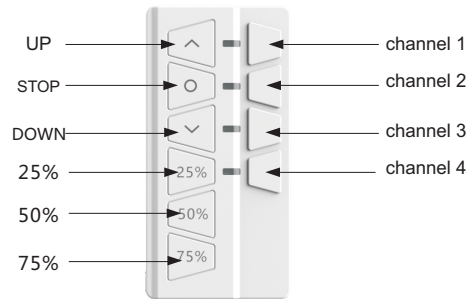

WSRE602-i  
Four Channel

Featured 3 intermediate Limits  
Position: 25%,50%,75%

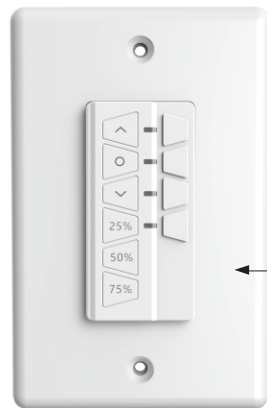

WSRE601-i-PLUS  
Single Channel

US Standard  
Decro Plate

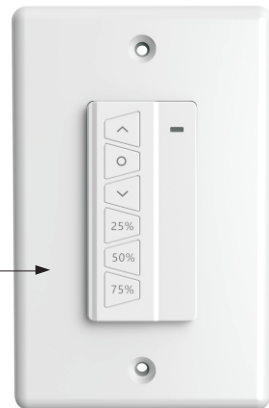

WSRE602-i-PLUS  
Four Channel

## 2. Technique Data

- Power: 3v Model CR2032
- Working Temperature: -20°C to +60°C
- Code: rolling code

- Currency : ≤16mA
- Frequency : 433.92MHz

## 3. Code learning

### single-channel emitter

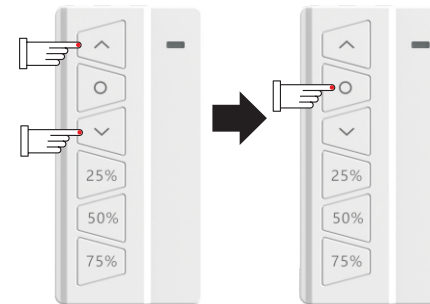

Make the motor at learning state (refer to motor's user manual), press emitter's Up and Down buttons simultaneously once, then short press Stop button once, the motor vibrates, the emitter is paired to the motor..

### 4 channel emitter

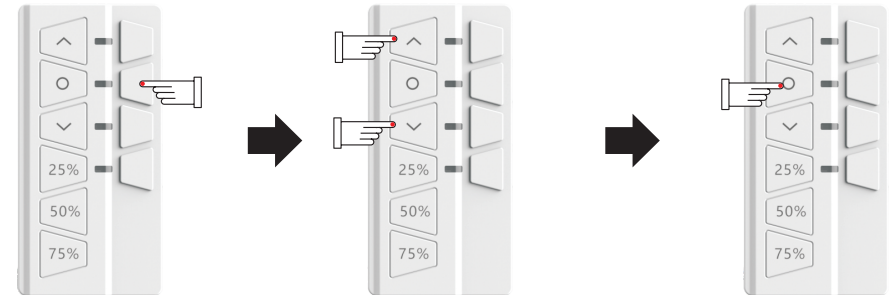

1). Short press the Channel Switch Button to select a channel (from 1 to 4), once selected, the corresponding light will shine.

2). Press UP and DOWN buttons simultaneously once.

3). Then short press the Stop button, now the code learning of the selected channel is successful. other channels to learn code in the same way.

## 4. Group control

Example: RE602 series could set four Channels, each channel with corresponding button and light.

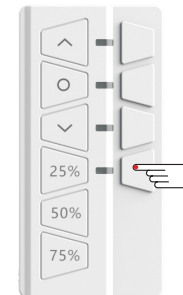

- a). During Sleep Mode(all lights are off),press any one switch button once, could check which channel have been set(corresponding light will shine).
- b). During channel checking (channel light are on), press the channel switch button again. If the channel haven't ever is set, it will be set now, if the channel have ever been set , it will be deleted now and corresponding light off.

# Emitter Instruction for RE601-i/RE602-i series

## 5. Percentage control

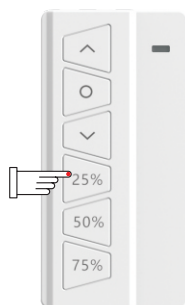

After code learning and UP & DOWN limit set, press the left buttons 25%,50%,75%, could control the percentage.

## 6. bracket installation

Way1 : Direct wall installation



Way2 : US Standard Decro Plate



### Note

- If you need set group control, you have to add or delete channels within 3-4s after checking channel.
- Only after code learning and limits are set ,you can control the percentage.
- You'd better not press the emitter's buttons too long so as to prolong the battery . The button press should be about 0.5s with 1s interval.
- The emitter will stop working if the battery is in low power. Please replace the battery in this case.